

FLUORESCENT

140 Series *Rustproof Vandal-Resistant Ceiling Luminaire*
Two 40 Watts Maximum

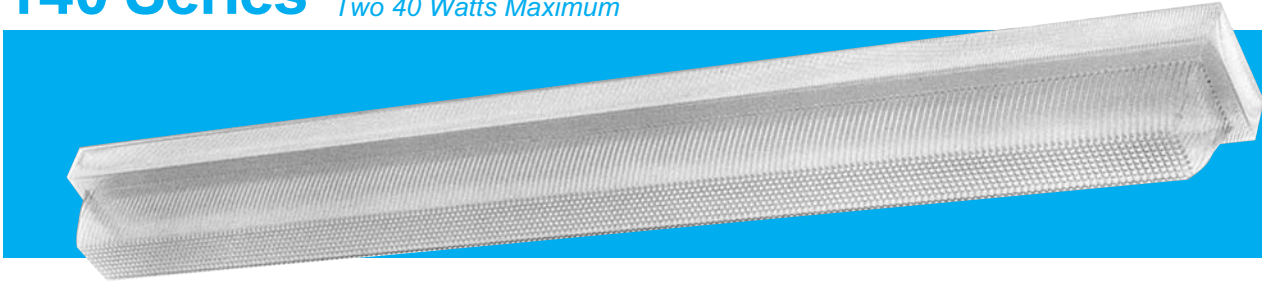

This fluorescent fixture combines optimal light distribution and energy efficiency with impact resistance in an aesthetically attractive design. Options such as an emergency battery system and a PL fluorescent night light eliminate the need for special-purpose lighting. For indoor and protected outdoor uses, this luminaire is perfect for schools, hospitals, prisons and public, commercial and government buildings.

Specifications

Lens: Pressure formed of UV-stabilized **polycarbonate** in average $\frac{1}{8}$ " thickness. Clear lens is enhanced with prisms engineered for maximum light control. End knockouts allow surface conduit or continuous row mounting.

Base Plate: Die formed of 20-gauge steel with high reflectance white baked enamel finish applied after forming (**Post Painted**). Provided with end knockouts for $\frac{1}{2}$ " conduit. 16-gauge steel available as option.

Gasket: Concealed polyethylene gasket is bonded to lens to create a tight seal against contaminants and moisture.

Wireway: Tool-less tab attachment facilitates installation and removal of wireway channel.

Ballast: Rapid-start, thermally protected Class P, high power factor ballast for 120, 277, or 347 volts, 50°F. Optional 0°F ballast available for F40T12 lamp. Optional electronic ballast available. U.S. product standard with energy saving ballast.

Lamp: (optional) 48" rapid-start bipin, either F40T12 or energy-saving F32T8; or two 22 $\frac{1}{2}$ " rapid-start four-pin 40 PLL twin tube.

Battery: (optional) Nickel cadmium battery is maintenance free with a life of 7-10 years and a 90-minute emergency operating time.* Exterior indicator light reveals that battery is charging during normal operations of fixture. During power interruption, lamp will switch to emergency operation. When A.C. power is restored, lamp is switched back to the ballast and the battery is recharged within 24 hours. Note: Can be wired to operate only during power interruption (see options).

Hardware: Six stainless-steel philips head screws or optional Torx® type tamperproof screws with speed nuts are provided for lens attachment.

UL Listed For Wet Locations. (Covered Ceiling Installations only)

All polycarbonate components meet Underwriters Laboratories 746C tests for polymeric material and carry a flammability rating of 94HB or better on lenses and the superior 94-5V rating on housings.

Fixture Type _____
Catalog Number _____
Job Name _____
Approval _____

Dimensions

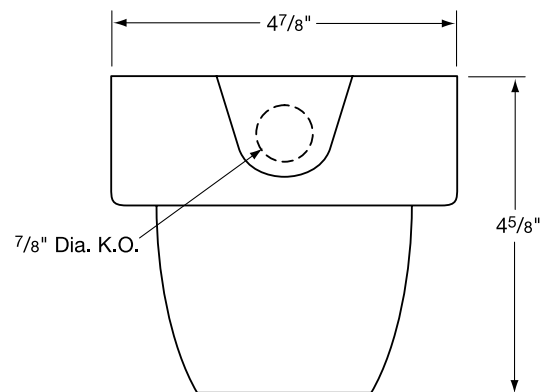

Base Plate Hole Pattern

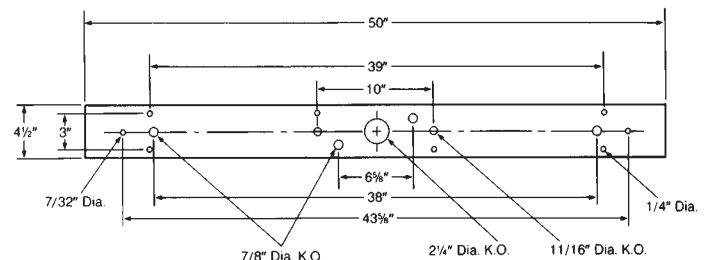

* For Wet Locations, specify option EMIW (suitable for 0°C/32°F Min. 50°C/122°F Max. temperature).

WF Harris Lighting

Innovative Lighting Solutions Since 1970

P.O. Box 5023, Monroe, NC 28111-5023, USA
(704) 283-7477 • (704) 283-6880 (FAX) • (800) 842-9345 (TOLL FREE)
www.wfharris.com • email: info@wfharris.com

"A Live Operator Company Standing Ready to Serve Your Lighting Needs"

FLUORESCENT

Ordering Information (Fill In Blanks For Complete Catalog Number)

Model	Lens	Watts-Lamp	Power Factor	Volts	Options
Model	Lens Color	Watts/Lamp	Power Factor	Volts	Options
140	CP-Clear Prismatic	40 FLT12 32 FLT8 2-40 PLL 54 FLT5	HPF	120 277 347	

Options
LP-F40T12, F32T8, or Two 40 PLL
AL-Marine Grade Aluminum Base Plate
CW-0°F Ballast (N/A With EM option) ¹
EB-Electronic Ballast
EM(1 Lamp)-One Lamp Operates Full Time and During Emergency
EM(2 Lamp)-2 Lamps Operate Full Time and 1 Lamp Operates During Emergency
EM2(2 Lamps)-2 Lamps Operate Full Time and 2 Lamps Operate During Emergency
EMO(1 Lamp)-One Lamp Only Operates During Emergency
EM01(2 Lamp)-1 Lamp Operates Full Time. 1 Lamp Operates Only During Emergency
EM02(2 Lamp)-Two Lamps Operate Only During Emergency
FS-Fuse and Holder
G16-16 Gauge Steel Base Plate
TPS-Stainless Steel Torx Type Tamperproof Screws with Speed Nuts

Accessories (Order Separately)
TPT-Tamperproof Screwdriver



¹ Available with 40W (F40T12) only
² Dry locations only.

Wet Location EM - Consult Factory.

Photometric Data

Model 140-CP-40 FL
Ceiling Mounted 7.5' M.H.
Test Report No. LRL 189-15A

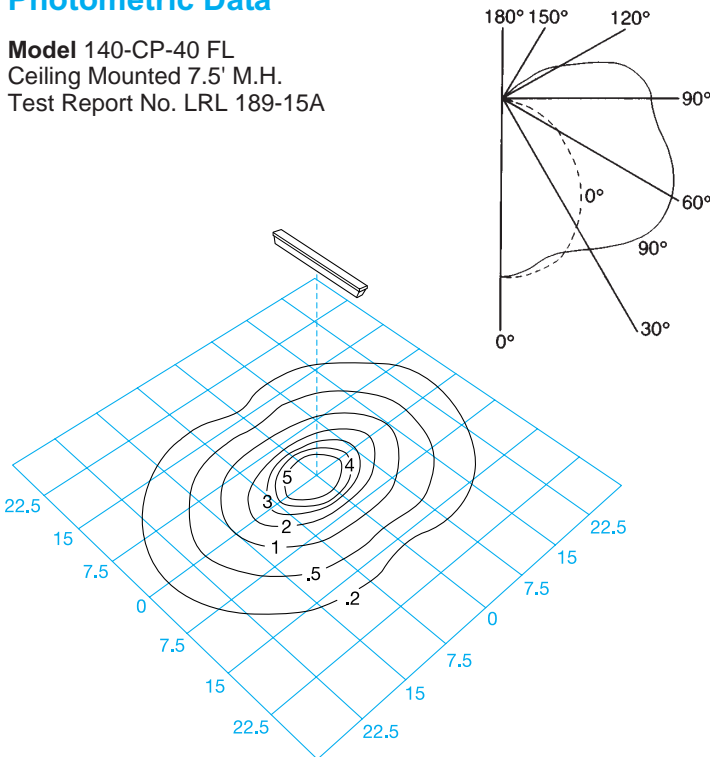

Lamp	Lamp Conversion Factor	Mounting Height	Height Conversion Factor
(2) 40 PLL	1.97	7.5'	1.00
40	1.00	10'	.56
32	.91	12'	.40
		14'	.29

Using Conversion Table

TO ADJUST FC, USE FOLLOWING FORMULA WITH LAMP CONVERSION FACTOR (LCF) AND HEIGHT CONVERSION FACTOR (HCF):

$$\begin{aligned} \text{FC} \times \text{LCF} &= \text{FC with alternate lamp} \\ \text{FC} \times \text{HCF} &= \text{FC at alternate height} \\ \text{FC} \times \text{LCF} \times \text{HCF} &= \text{FC with alternate lamp at alternate height} \end{aligned}$$

Specifications Subject to Change Without Notice

Fixture is Warranted to be Free of Defects in Materials and Workmanship for One Year From Invoice Date.

MADE IN USA

COEFFICIENTS OF UTILIZATION — ZONAL CAVITY METHOD
EFFECTIVE FLOOR CAVITY REFLECTANCE 0.20

RC	80				70				50				30				10				0
	RW	70	50	30	10	70	50	30	10	50	30	10	50	30	10	50	30	10	0		
1	77	72	67	63	73	69	64	61	62	59	56	56	54	51	51	49	47	44	44		
2	69	61	55	49	65	58	53	48	53	48	44	48	44	40	43	40	37	34	34		
3	62	53	46	40	59	51	44	39	46	40	36	41	37	33	37	34	31	28	28		
4	57	46	39	33	53	44	37	32	40	34	30	36	31	27	33	29	25	23	23		
5	52	41	33	28	49	39	32	27	35	29	25	32	27	23	29	25	21	19	19		
6	48	36	29	24	45	35	28	23	32	26	21	29	24	20	26	22	19	16	16		
7	44	33	25	20	41	31	25	20	28	23	18	26	21	17	24	19	16	14	14		
8	40	29	22	18	38	28	22	17	26	20	16	23	19	15	21	17	14	12	12		
9	38	27	20	16	36	26	19	15	23	18	14	21	17	13	20	15	12	11	11		
10	35	24	17	13	33	23	17	13	21	16	12	19	14	11	17	13	10	9	9		

WF Harris Lighting

Innovative Lighting Solutions Since 1970

P.O. Box 5023, Monroe, NC 28111-5023, USA
(704) 283-7477 • (704) 283-6880 (FAX) • (800) 842-9345 (TOLL FREE)
www.wfharris.com • email: info@wfharris.com

Printed in USA
Form 1539 (R7) 9/98